

INTERNATIONAL ENERGY CONSERVATION CODE 1990 DESIGN BY ACCEPTABLE PRACTICE FOR COMMERCIAL BUILDINGS FROM TABLE D02.2 (13)					
GROSS WALL AREA:		1232 SQ. FT.			
GROSS GLAZING AREA:		264 SQ. FT.			
GLAZING AREA PERCENTAGE:		22%			
BASED ON THE GLAZING AREA PERCENTAGE, THE FOLLOWING CHART IS UTILIZED FOR THIS PROJECT.					
BUILDING ENVELOPE REQUIREMENTS - CLIMATE ZONE 4B					
WINDOW AND GLAZED DOOR AREA OVER 10 PERCENT BUT NOT GREATER THAN 25 PERCENT ABOVE GRADE WALL AREA					
ELEMENT	CONDITION/VALUE		DESIGN		
SKYLIGHTS (U-FACTOR)	1		N/A		
SLAB OR BELOW GRADE WALL (R-VALUE)	R-0		N/A		
WINDOWS AND GLASS DOORS	SHGC	U-FACTOR	SHGC	U-FACTOR	
FF10-25	.9	ANY	---	---	
0.251 OR - FF10-50	.7	ANY	---	S5	
FF10-0.25	ANY	ANY	S2	---	
ROOF ASSEMBLIES (R-VALUE)	CONTINUOUS INSULATION		CONTINUOUS INSULATION		
ALL-WOOD JOIST/TRUSS	R-15	R-15	R-15	---	
METAL JOIST/TRUSS	R-25	R-17	R-10	---	
CONCRETE SLAB OR DECK	NA	---	---	---	
METAL PURLIN WITH THERMAL BLOCK	R-25	R-17	---	---	
METAL PURLIN WITHOUT THERMAL BLOCK	X	R-17	---	---	
FLOORS OVER OUTDOOR AIR OR UNCONDITIONED SPACE (R-VALUE)	CONTINUOUS INSULATION		CONTINUOUS INSULATION		
ALL-WOOD JOIST/TRUSS	R-11	R-4	---	---	
METAL JOIST/TRUSS	R-11	R-4	---	---	
CONCRETE SLAB OR DECK	NA	R-4	---	---	
ABOVE GRADE WALLS (R-VALUE)	NO FRAMING		METAL FRAMING		WOOD FRAMING
FRAMED	NA	R-11	R-11	---	R-19
R-VALUE CAVITY	NA	R-0	R-0	---	---
R-VALUE CONTINUOUS	NA	R-0	R-0	---	---
CMU, OR - CMU WITH INTEGRAL INSULATION	NA	R-0	R-0	---	---
R-VALUE CAVITY	NA	R-0	R-0	---	---
R-VALUE CONTINUOUS	NA	R-0	R-0	---	---
OTHER MASONRY WALLS	NA	R-11	R-11	---	---
R-VALUE CAVITY	NA	R-0	R-0	---	---
R-VALUE CONTINUOUS	NA	R-0	R-0	---	---

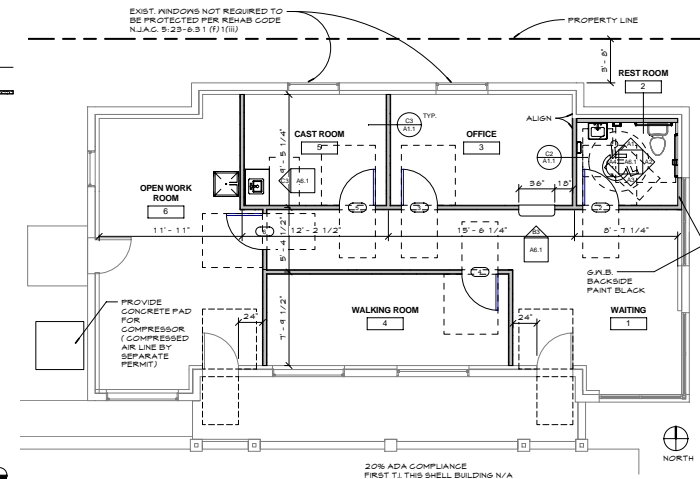
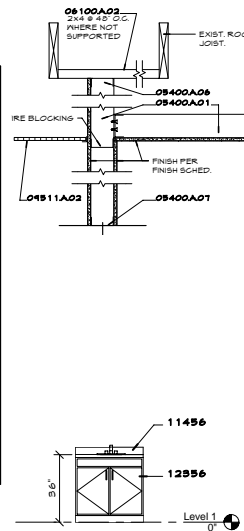

ARIZONA

Arizona Prosthetic Orthotic Services (APOS) is a leading manufacturer and retailer of prosthetic and orthotic products. They serve Scottsdale, Phoenix and Tucson; they also serve rural areas through their mobile lab. Equipped to use state-of-the-art technology including computer-aided socket design and the Otto Bock C-Leg, and they are the first Arizona facility to utilize bionic prosthetic technology, the Ossur Proprio foot.

The Tucson location at 2933 N. Campbell Avenue was designed as a full service location providing the above services. The build-out includes a waiting area, an accessible toilet room, an office, a casting room, an open work room, and an indoor walking room for fittings. Total build-out was 1229 square feet.

PROSTHETIC

Location
2933 N. CAMPBELL AVE., TUCSON, AZ

Client
ARIZONA PROSTHETIC ORTHOTIC SERVICES

Contract Value
N/A

Completion Date
APRIL 2004

Project Size
1229 SQ FT

bda
BRIGHT DESIGN ASSOCIATES